

PREMIER COLLECTION

The Enrick and The Evelix

2 bedroom en suite apartments





Enrick Lounge

Block 1



Second Floor



First Floor



Ground Floor

Block 2



Second Floor



First Floor



Ground Floor



Enrick Master Bedroom



Evelix Kitchen

THE ENRICK AND THE EVELIX

2 bedroom en suite apartments

Contemporary and stylish two bedroom en suite apartments within easy reach of the city attractions of Inverness. The Enrick and The Evelix are finished to an excellent specification, including flooring throughout and a stunning Ashley Ann kitchen featuring integrated oven, hob, canopy hood, fridge freezer and washer dryer. The master bedroom boasts an en suite shower room and both en suite and bathroom are finished with vanity units, creating a sleek, streamlined look. In addition most rooms benefit from 2.7m high ceilings creating a bright and airy atmosphere throughout.

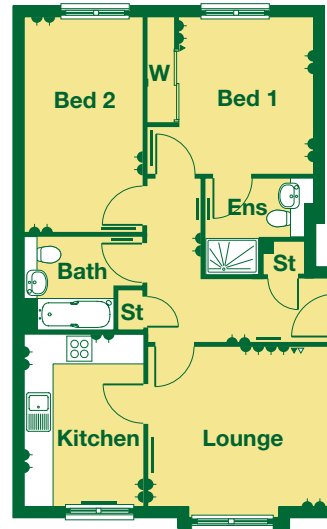

The Enrick

Lounge	4.13m x 3.63m	13' 7" x 11' 11"
Kitchen	3.90m x 2.65m	12' 10" x 8' 8"
Bedroom 1	3.55m x 3.03m	11' 8" x 9' 11"
En suite	2.43m x 2.17m	8' 0" x 7' 1"
Bedroom 2	4.87m x 2.69m	16' 0" x 8' 10"
Bathroom	2.71m x 2.10m	8' 10" x 6' 11"

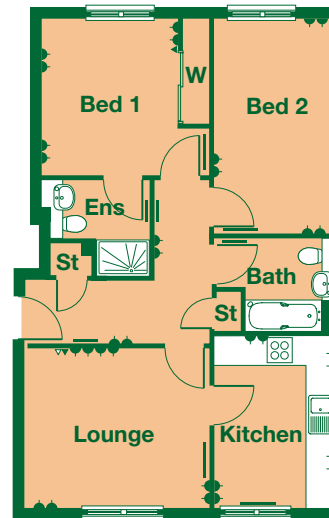

The Evelix

Lounge	4.13m x 3.63m	13' 7" x 11' 11"
Kitchen	3.90m x 2.69m	12' 10" x 8' 10"
Bedroom 1	3.55m x 3.03m	11' 8" x 9' 11"
En suite	2.18m x 2.17m	7' 2" x 7' 1"
Bedroom 2	4.87m x 2.71m	16' 0" x 8' 10"
Bathroom	2.69m x 2.10m	8' 10" x 6' 11"

Specification

Kitchen

- Stylish top quality kitchen* supplied and fitted by highly respected Ashley Ann
- Stainless steel inset 1.5 bowl kitchen sink
- Egger range worktop and matching splashback*

- Multi directional ceiling spotlight

Top of the range Bosch appliances

- Bosch stainless steel electric oven
- Bosch 4 zone ceramic hob
- Stainless steel Elica canopy hood
- Bosch integrated fridge freezer
- Bosch washer dryer

"We choose Bosch appliances in our homes, designed to make everyday life easier – with appliances which are intuitive to use."

Bathroom and en suite

- Featuring Ideal Standard Tempo range sanitary ware
- Contemporary Calista mono-mixer lever tap
- Large statement mirror in bathroom and en suite
- Environmentally friendly water saving thermostatic shower with unique design shower head to bathroom
- Contemporary ceramic wall tiling* above vanity units* and around showers

Plumbing and Heating

- Baxi Potterton gas fired central heating
- Thermostatically controlled radiators and towel rails

Internal Finishes and Decoration

- Stylish MDF facings, skirtings, window cills and apron plates
- Modern white Premdor internal doors
- Serozzetta Morado polished chrome ironmongery
- Walls and ceiling finished with white matt emulsion
- Woodwork finished with brilliant white satinwood paint

Fitted Wardrobes and Storage

- Sliding mirrored wardrobe doors with satin trim
- White shelf and chrome hanging rail to wardrobe

All apartments include quality fitted flooring throughout.

Security and External Details

- Premium white oak front door set with multi point locking system, spy viewer, low access threshold and letter plate
- Modern double glazed windows with lockable handles except dedicated fire escape windows
- Mains-fed smoke and heat alarms with battery back-up
- Communal area consisting of hallway, stairs and landing finished with durable quality carpeting
- Secure door entry system with telephone handset to each apartment

Electrics and Connectivity

- TV/Sky Q point in lounge and master bedroom
- Master BT point located in lounge
- Fibre broadband to the property provides high speed internet connectivity

*Choice of colour dependent on construction programme.

We operate a policy of continuous product development, and specification, floor plans and individual features such as windows, garages and elevational treatments may vary from time to time, as may heating and electrical layouts. Consequently these particulars should be treated as general guidance only and cannot be relied upon as accurately describing any of the areas or items prescribed. Nor do they constitute a contract, part of a contract or a warranty.